

OPEN GARAGE OF JYOTI COTTAGE ROW HOUSE- 1

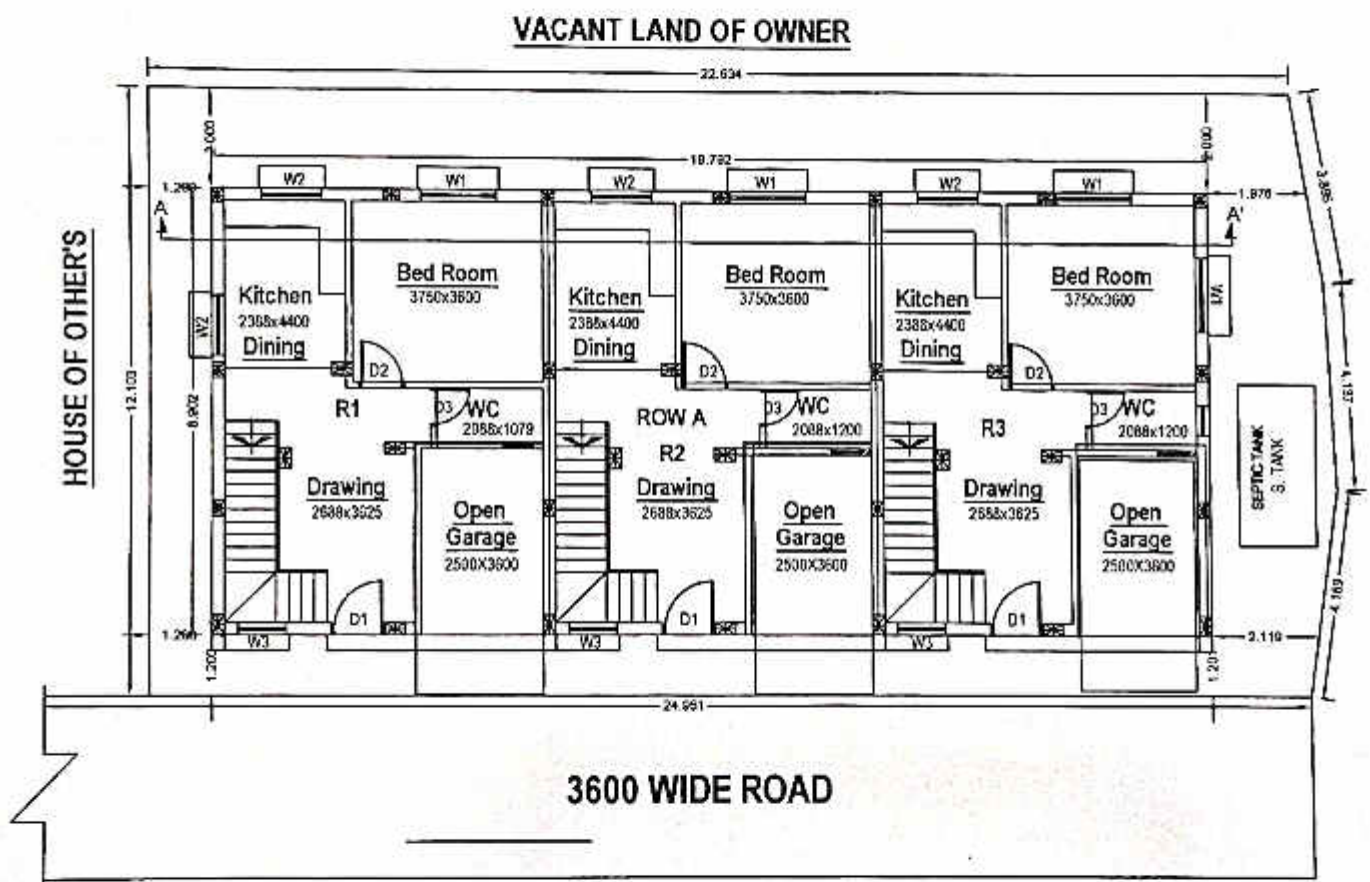

SITE PLAN WITH GROUND FLOOR PLAN



Netflex Homes Private Limited
M. V. Kalin...
Director



Site Office:
JYOTI NAGAR, SHAKESPEARE SARANI,
NEAR - WEBEL IT PARK, ASANSOL - 713302
WEST BENGAL

TO WHOM IT MAY CONCERN

This is to inform that the proposed project "JYOTI COTTAGE ROW HOUSE-1" situated at Shakespeare Sarani, jyotinagar near webel it park, Asansol over R.S. & L.R. plot no.- 937, 939, L.R. Khatian no.- 957, 3199, MOUZA- Gobindapur, j.l. no.- 18, under P.S.- Asansol (N), District- Paschim Bardhaman, West Bengal, within the pin 713341, includes **following open Garage space in the Project sanctioned**

SL. NO.	BLOCK NO.	NUMBER OF COVERED GARAGE	NUMBER OF OPEN GARAGE	TOTAL (OPEN GARAGE)
1	ROW HOUSE-1	0	3	3

For NETFLEX HOMES PRIVATE LIMITED

Netflex Homes Private Limited
Md. Kalimuddin
Director

Md. KALIMUDDIN
Authorized Signatory



HEAD OFFICE: NETFLEX HOMES PVT .LTD.576(NEW) BYE PASS ROAD,SITALA,BESIDE RELIENCE MARKET,
ASANSOL-713325 DIST.PASCHIM BARDHAMAN, WEST BENGAL
WEBSITE: WWW.NETFLXHOMES.COM/E MAIL:NETFLEXASANSOL18@GMAIL.COM
PH- 918927758026/917797620275